

THE MERCER LEVER

designed by Cutler Anderson Architects



REVEAL DESIGNS®

LEVERS & KNOBS

THE MERCER LEVER

designed by Cutler Anderson Architects



Image 1 (#104-32D)



Image 2 (#104-10B)



Image 3 (#104-CW)

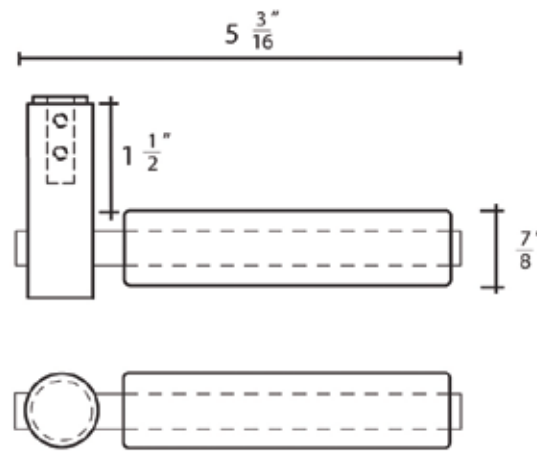

Image 4 (#104-WW)

DESIGN AND FUNCTION

- Designed to reveal mechanics of lever
- Cylindrical grip easy to the touch
- Offered in a variety of metals and woods
- Wood handle versions warm to the touch
- Metal handle versions installed on both interior and exterior doors
- Functions with tubular latches, mortise and multipoint locks
- Handcrafted in U.S.A.

DIMENSIONS AND FIGURES



Product No. 104

* Functions with 8mm on Square Spindle

AVAILABLE IN

- Beech / Stainless Steel
- Walnut / Stainless Steel (Image 4)
- All Stainless Steel (Image 1)
- Oil Rubbed Bronze / Stainless Steel (Image 2)
- Anodized Aluminum / Stainless Steel
- Cherry / Stainless Steel (Image 3) (Custom Wood)

All Stainless Steel components manufactured using No. 304 Stainless Steel

All Oil Rubbed Bronze components manufactured from a silicon bronze base with a live finish
Custom Metals and Woods Available Upon Request (e.g., Walnut / Oil Rubbed Bronze - Custom)

products@reveal-designs.com

www.reveal-designs.com

914 220 0277



REVEAL DESIGNS®

LEVERS & KNOBS